



WESTCLIFF



Highlights

Centre Valleyfield is the only shopping center in the region with a gross leasable area of 273,011 square feet and more than 46 permanent tenants.

The population of the MRC Beauharnois-Valleyfield, bringing together the cities of Haut St-Laurent, is approximately 64,320 inhabitants.

Sales per square foot are approximately \$690

Annual visits exceed 1,500,000 million people.

Market

62K

PRIMARY MARKET

40K

SECONDARY MARKET

39,8

AVERAGE
AGE*



+2.9%

POPULATION
GROWTH*

2016 vs 2021



Property highlights

56

TENANTS



1

RESTAURANTS



Major tenants



*Source : Statistics Canada



273,011 Square feet

- Resto 4
- Local 52

The mall is located in the heart of the city of Valleyfield, directly adjacent to a strong residential market. It is the only enclosed mall located in a large geographic area, and it services the entire south-west portion of the Montérégie region of Québec. Centre Valleyfield underwent a complete interior and exterior renovation in 2006, and offers a mix of fashion-oriented boutiques and service stores.

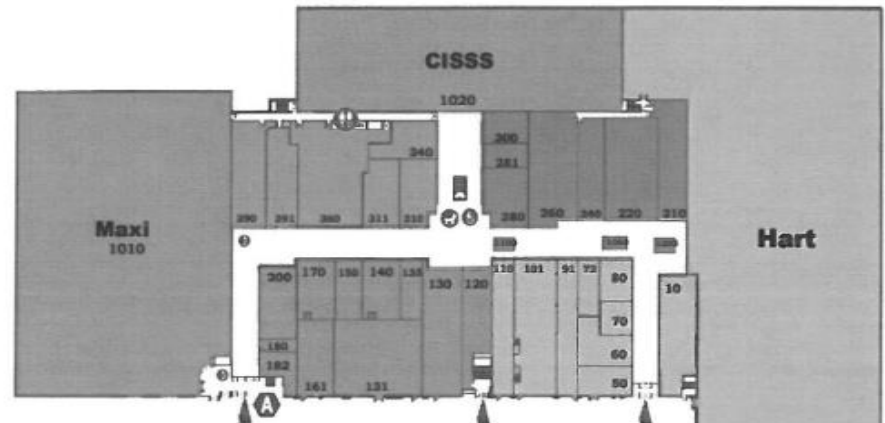
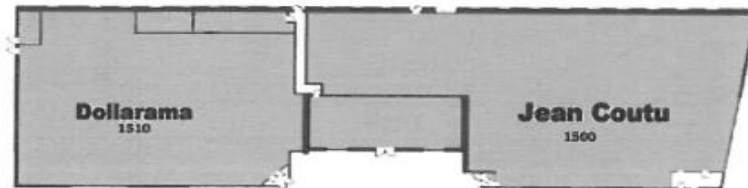

Accessoire mode/Bijoux 310 Boutique SHOB 360 Ardène	Cinéma 1030 Cinéma 7	Pharmacie 1500 Jean Coutu	Téléphonie 66 Bell 72 Rogers Plus 55 Videotron 220 Expert du mobile 1060 Koodo Mobile	Vêtement dame 170 Zacks 131 Le Grenier 311 Mode Kulo 390 Top mode / Passion Lingerie 391 Calan
Alimentation 1010 Maxi	Cuisine et articles 120 Stokes	Restaurants 161 Subway	Vêtements unisexes 80 Mode Kimo 130 Pentagone	Heures d'ouverture Lundi au mercredi 9h30 à 17h30 Jeudi et vendredi 9h30 à 21h00 Samedi 9h00 à 17h00 Dimanche 10h00 à 17h00
Bijouterie 110 Diamant Élixir	Soin beauté/Coiffure 70 Ongles Modernes 280 Coiffure d'Ariane 240 Lucky Parfumerie	Spécialité 10 P.L. Graphique 180 Cordonnerie		
Vaccination 1020 CISSS	Magasin à rayons 1000 Hart 1510 Dollarama	Valise 200 Bentley		

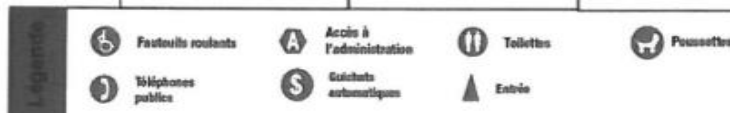

Contact us

LEASING

Nicolas D'Aoust
Vice-President, Leasing
514 499-8337
ndaoust@westcliff.ca

MALL MANAGER

Manon Lefebvre
General Manager
450 371-3366
manon.lefebvre@centrevallfield.com

